

How To Make a Paper Snowflake

Winter is coming! Follow these simple directions to get started creating your own snowflakes. Use this template to create the snowflakes shown in the following pages.

What you'll need:

- Paper
- Scissors

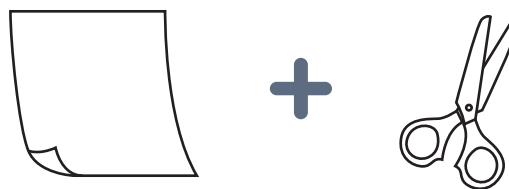

Step One

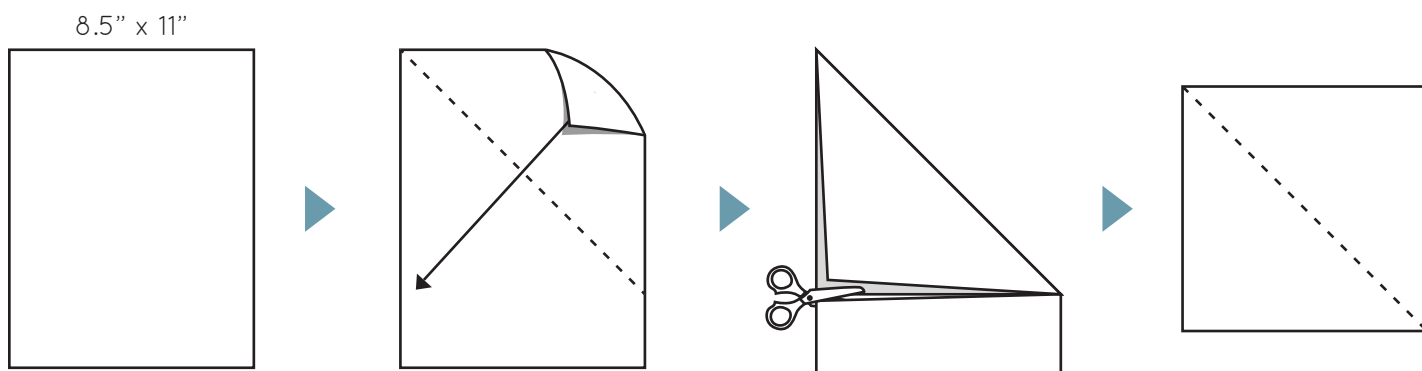

This first step is necessary only if you are using a piece of paper that measures 8.5" x 11" (also known as "printer paper"). Take the upper right corner of the paper and fold it down diagonally so it lines the left side of the paper. While folded, cut off the excess paper to create a perfect square.

Step Two

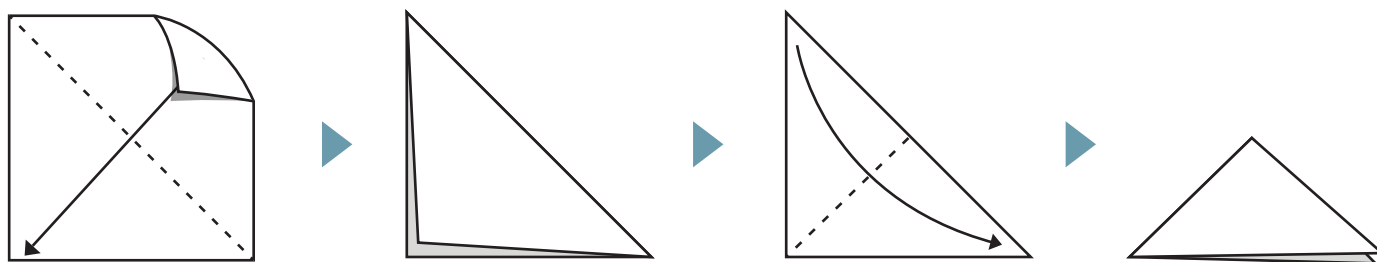

Next, take the square and fold it again in half diagonally, **top-right** corner to **bottom-left** corner. Then take the **top-left** corner of that triangle and fold it down to the **bottom-right** corner of the triangle to make a smaller triangle.

Step Three

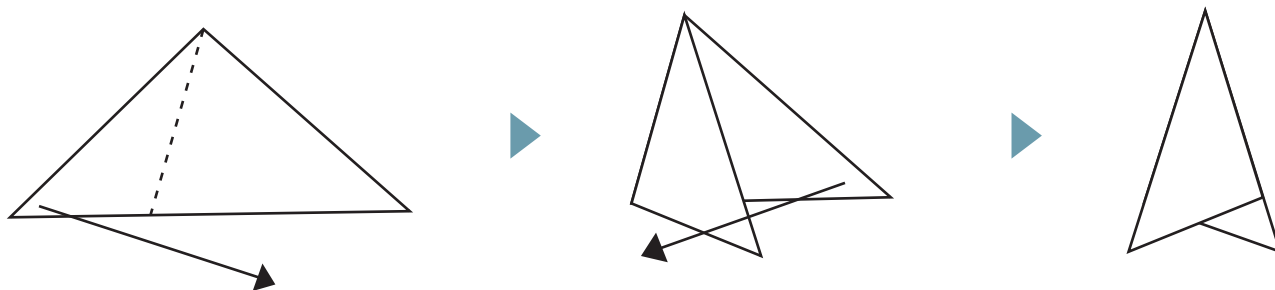

Take the left point of the triangle and fold it 1/3 of the way over to the right. Then take the right point of the triangle and fold it over the remaining third of the way. Each side should line up evenly.

Step Four

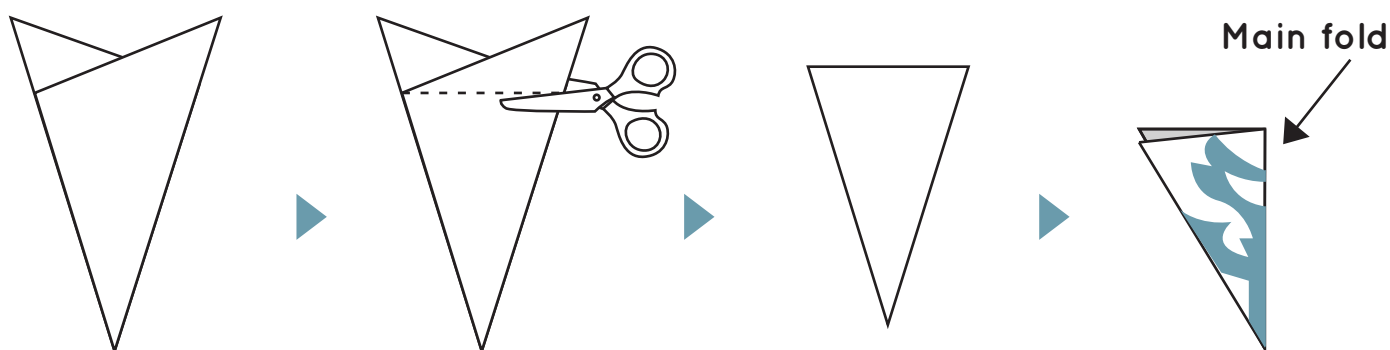

Lastly, cut off the remaining corners by cutting a straight horizontal line, leaving a triangle. Then fold the triangle in half by folding the right corner over to the left corner.

Now you're ready to design your own snowflake!

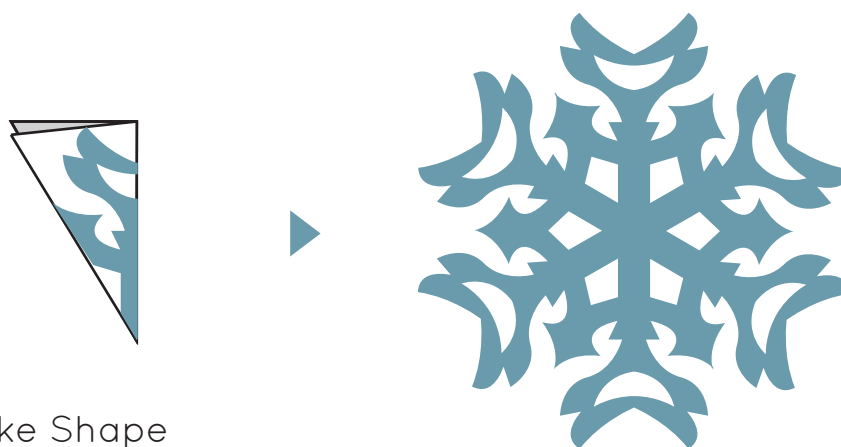

-  Cut off
-  Final Snowflake Shape